

NOTES

1. ALL WATER RETICULATION CONSTRUCTION TO BE IN ACCORDANCE WITH CVC & WSSA REQUIREMENTS
2. PROVIDE THRUST BLOCKS TO ALL BENDS AND FITTINGS IN ACCORDANCE WITH WSSA REQUIREMENTS AND STANDARD DRAWINGS

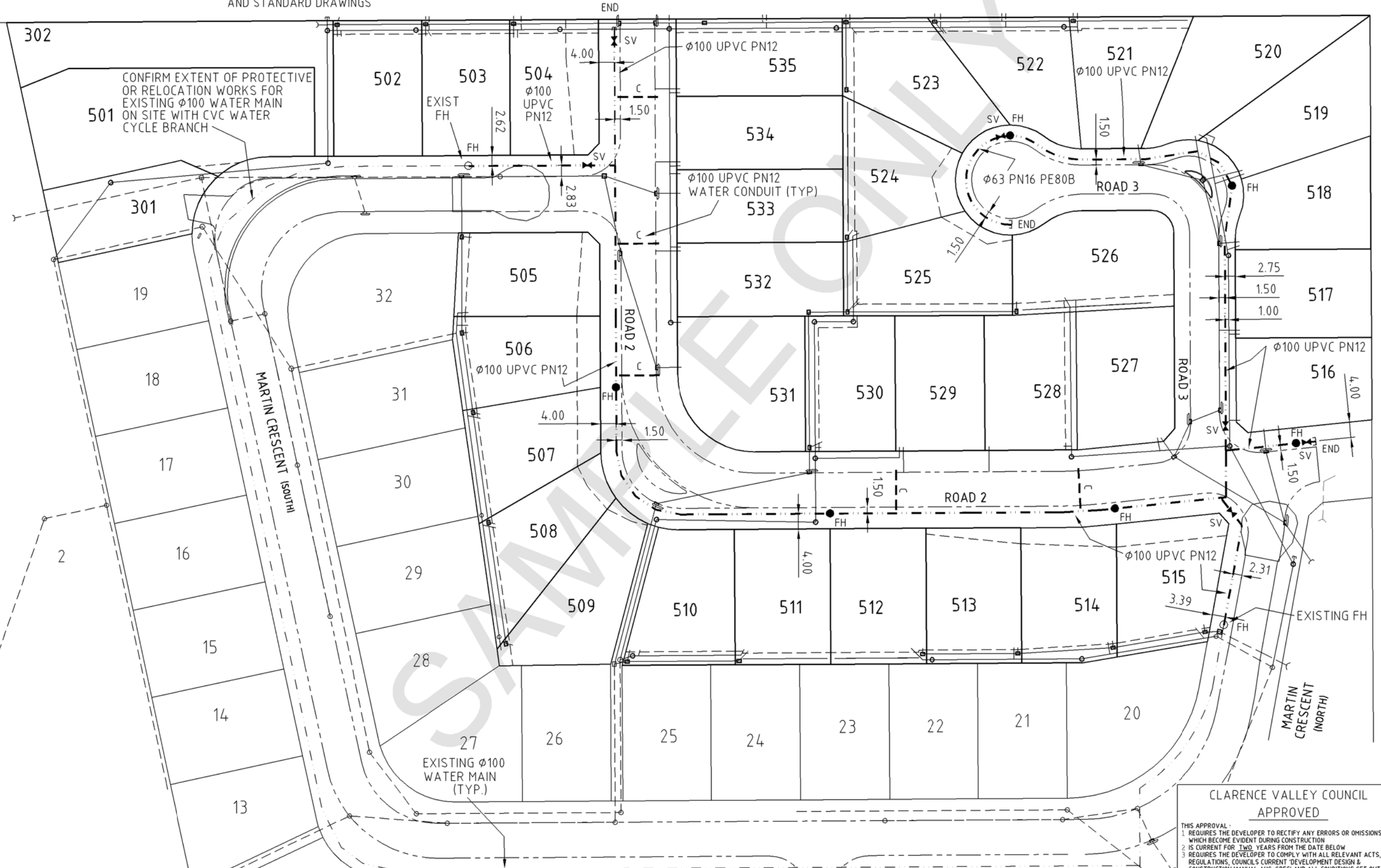

CONFIRM EXTENT OF PROTECTIVE OR RELOCATION WORKS FOR EXISTING $\phi 100$ WATER MAIN ON SITE WITH CVC WATER CYCLE BRANCH

EXISTING $\phi 100$ WATER MAIN (TYP.)

CLARENCE VALLEY COUNCIL
APPROVED

THIS APPROVAL:
 1. REQUIRES THE DEVELOPER TO RECTIFY ANY ERRORS OR OMISSIONS WHICH BECOME EVIDENT DURING CONSTRUCTION
 2. IS CURRENT FOR TWO YEARS FROM THE DATE BELOW
 3. REQUIRES THE DEVELOPER TO COMPLY WITH ALL RELEVANT ACTS, REGULATIONS, COUNCIL'S CURRENT 'DEVELOPMENT DESIGN & CONSTRUCTION MANUAL AUS-SPEC' AND ALL CONDITIONS SET OUT IN:

DEVELOPMENT APPROVAL No's SUB2011/xxxxx
 CONSTR. CERT. No. CC2011/xxxxx CHECKED _____ DATE _____
 ISSUING OFFICER FOR GENERAL MANAGER

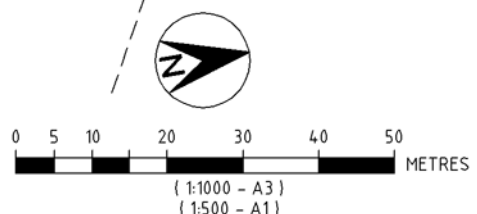

CAD FILE	
SURVEY	JM & AR
VERT. DATUM	AHD
HORIZ. DATUM	-
AZUMITH	-
DATE	Mar08

DESIGN	ID	Mar08
DRAWN	ID	Mar08
PASSED		
MANAGER CIVIL STRATEGIC		DATE

ISSUE	AMENDMENTS	BY	DATE
A	Construction Certificate Application	ID	6-09
B	Works to exist 100 dia. WM near Lot 501 & CC Approval	RD-B	29-6-09



BAILEYS ESTATE STAGE 2
 DEVELOPMENT APPLICATION
 WATER RETICULATION LAYOUT PLAN

SHEET No.	18 OF 35
PLAN No.	2008-006
ISSUE	B