

Licence Variation



Licence - 5880

LISMORE CITY COUNCIL
ABN 60 080 932 837
PO BOX 23A
LISMORE NSW 2480

Attention: Aleisha Went

Notice Number 1637893
File Number EF13/4810
Date 27-Mar-2024

NOTICE OF VARIATION OF LICENCE NO. 5880

BACKGROUND

- A. LISMORE CITY COUNCIL ("the licensee") is the holder of Environment Protection Licence No. 5880 ("the licence") issued under the *Protection of the Environment Operations Act 1997* ("the Act"). The licence authorises the carrying out of activities at 313 WYRALLAH ROAD, EAST LISMORE, NSW, 2480 ("the premises").
- B. On 15 March 2024 the Environment Protection Authority (EPA) received a request from Lismore City Council to vary the licence by extending the expiration date for the on site leachate treatment trial. A minor typographical error in condition L2.1 has also been amended by this variation.
- C. The EPA has considered the matters detailed in s45 of the Act in the making of this licence variation.

VARIATION OF LICENCE NO. 5880

1. By this notice the EPA varies licence No. 5880. The attached licence document contains all variations that are made to the licence by this notice.
2. The following variations have been made to the licence:
 - condition E3.1 - amended
 - condition L2.1 - amended

Licence Variation



A handwritten signature in black ink, appearing to read 'LD', is written over a horizontal dotted line.

Luke Davison
Unit Head - Operations
Environment Protection Authority
(by Delegation)

INFORMATION ABOUT THIS NOTICE

- This notice is issued under section 58(5) of the Act.
- Details provided in this notice, along with an updated version of the licence, will be available on the EPA's Public Register (<http://www.epa.nsw.gov.au/prpoeo/index.htm>) in accordance with section 308 of the Act.

Appeals against this decision

- You can appeal to the Land and Environment Court against this decision. The deadline for lodging the appeal is 21 days after you were given notice of this decision.

When this notice begins to operate

- The variations to the licence specified in this notice begin to operate immediately from the date of this notice, unless another date is specified in this notice.
- If an appeal is made against this decision to vary the licence and the Land and Environment Court directs that the decision is stayed the decision does not operate until the stay ceases to have effect or the Land and Environment Court confirms the decision or the appeal is withdrawn (whichever occurs first).

Environment Protection Licence

Licence - 5880

Licence Details

Number:	5880
Anniversary Date:	01-July

Licensee

LISMORE CITY COUNCIL

PO BOX 23A

LISMORE NSW 2480

Premises

WYRALLAH ROAD WASTE FACILITY

313 WYRALLAH ROAD

EAST LISMORE NSW 2480

Scheduled Activity

Waste disposal (application to land)

Fee Based Activity

Waste disposal by application to land

Scale

Any capacity

Contact Us

NSW EPA

6 Parramatta Square

10 Darcy Street

PARRAMATTA NSW 2150

Phone: 131 555

Email: info@epa.nsw.gov.au

Locked Bag 5022

PARRAMATTA NSW 2124



Environment Protection Licence

Licence - 5880

INFORMATION ABOUT THIS LICENCE	4
Dictionary	4
Responsibilities of licensee	4
Variation of licence conditions	4
Duration of licence	4
Licence review	4
Fees and annual return to be sent to the EPA	4
Transfer of licence	5
Public register and access to monitoring data	5
1 ADMINISTRATIVE CONDITIONS	6
A1 What the licence authorises and regulates	6
A2 Premises or plant to which this licence applies	6
A3 Information supplied to the EPA	7
2 DISCHARGES TO AIR AND WATER AND APPLICATIONS TO LAND	7
P1 Location of monitoring/discharge points and areas	7
3 LIMIT CONDITIONS	11
L1 Pollution of waters	11
L2 Waste	12
L3 Noise limits	12
L4 Hours of operation	13
L5 Potentially offensive odour	13
4 OPERATING CONDITIONS	13
O1 Activities must be carried out in a competent manner	13
O2 Maintenance of plant and equipment	13
O3 Dust	13
O4 Emergency response	13
O5 Processes and management	14
O6 Waste management	14
O7 Other operating conditions	15
5 MONITORING AND RECORDING CONDITIONS	16
M1 Monitoring records	16
M2 Requirement to monitor concentration of pollutants discharged	16
M3 Testing methods - concentration limits	19
M4 Weather monitoring	19
M5 Recording of pollution complaints	20



Environment Protection Licence

Licence - 5880

M6	Telephone complaints line	20
M7	Requirement to monitor volume or mass	20
6	REPORTING CONDITIONS	21
R1	Annual return documents	21
R2	Notification of environmental harm	22
R3	Written report	22
R4	Annual system performance report	23
R5	Other reporting conditions	23
7	GENERAL CONDITIONS	24
G1	Copy of licence kept at the premises or plant	24
8	SPECIAL CONDITIONS	24
E1	Cell 1 Phytocap	24
E2	Special Dictionary	24
E3	Leachate Treatment Trial and Discharge	25
	DICTIONARY	26
	General Dictionary	26

Environment Protection Licence

Licence - 5880

Information about this licence

Dictionary

A definition of terms used in the licence can be found in the dictionary at the end of this licence.

Responsibilities of licensee

Separate to the requirements of this licence, general obligations of licensees are set out in the Protection of the Environment Operations Act 1997 ("the Act") and the Regulations made under the Act. These include obligations to:

- ensure persons associated with you comply with this licence, as set out in section 64 of the Act;
- control the pollution of waters and the pollution of air (see for example sections 120 - 132 of the Act);
- report incidents causing or threatening material environmental harm to the environment, as set out in Part 5.7 of the Act.

Variation of licence conditions

The licence holder can apply to vary the conditions of this licence. An application form for this purpose is available from the EPA.

The EPA may also vary the conditions of the licence at any time by written notice without an application being made.

Where a licence has been granted in relation to development which was assessed under the Environmental Planning and Assessment Act 1979 in accordance with the procedures applying to integrated development, the EPA may not impose conditions which are inconsistent with the development consent conditions until the licence is first reviewed under Part 3.6 of the Act.

Duration of licence

This licence will remain in force until the licence is surrendered by the licence holder or until it is suspended or revoked by the EPA or the Minister. A licence may only be surrendered with the written approval of the EPA.

Licence review

The Act requires that the EPA review your licence at least every 5 years after the issue of the licence, as set out in Part 3.6 and Schedule 5 of the Act. You will receive advance notice of the licence review.

Fees and annual return to be sent to the EPA

For each licence fee period you must pay:

- an administrative fee; and
- a load-based fee (if applicable).



Environment Protection Licence

Licence - 5880

The EPA publication “A Guide to Licensing” contains information about how to calculate your licence fees. The licence requires that an Annual Return, comprising a Statement of Compliance and a summary of any monitoring required by the licence (including the recording of complaints), be submitted to the EPA. The Annual Return must be submitted within 60 days after the end of each reporting period. See condition R1 regarding the Annual Return reporting requirements.

Usually the licence fee period is the same as the reporting period.

Transfer of licence

The licence holder can apply to transfer the licence to another person. An application form for this purpose is available from the EPA.

Public register and access to monitoring data

Part 9.5 of the Act requires the EPA to keep a public register of details and decisions of the EPA in relation to, for example:

- licence applications;
- licence conditions and variations;
- statements of compliance;
- load based licensing information; and
- load reduction agreements.

Under s320 of the Act application can be made to the EPA for access to monitoring data which has been submitted to the EPA by licensees.

This licence is issued to:

LISMORE CITY COUNCIL
PO BOX 23A
LISMORE NSW 2480

subject to the conditions which follow.

Environment Protection Licence

Licence - 5880

1 Administrative Conditions

A1 What the licence authorises and regulates

A1.1 This licence authorises the carrying out of the scheduled activities listed below at the premises specified in A2. The activities are listed according to their scheduled activity classification, fee-based activity classification and the scale of the operation.

Unless otherwise further restricted by a condition of this licence, the scale at which the activity is carried out must not exceed the maximum scale specified in this condition.

Scheduled Activity	Fee Based Activity	Scale
Waste disposal (application to land)	Waste disposal by application to land	Any capacity

A2 Premises or plant to which this licence applies

A2.1 The licence applies to the following premises:

Premises Details
WYRALLAH ROAD WASTE FACILITY
313 WYRALLAH ROAD
EAST LISMORE
NSW 2480
PART LOT 2 DP 1213261
ON MAP 15/081 DRAWN BY NEWTON DENNY CHAPELLE

A2.2 The premises location is shown on the map below.

Environment Protection Licence

Licence - 5880

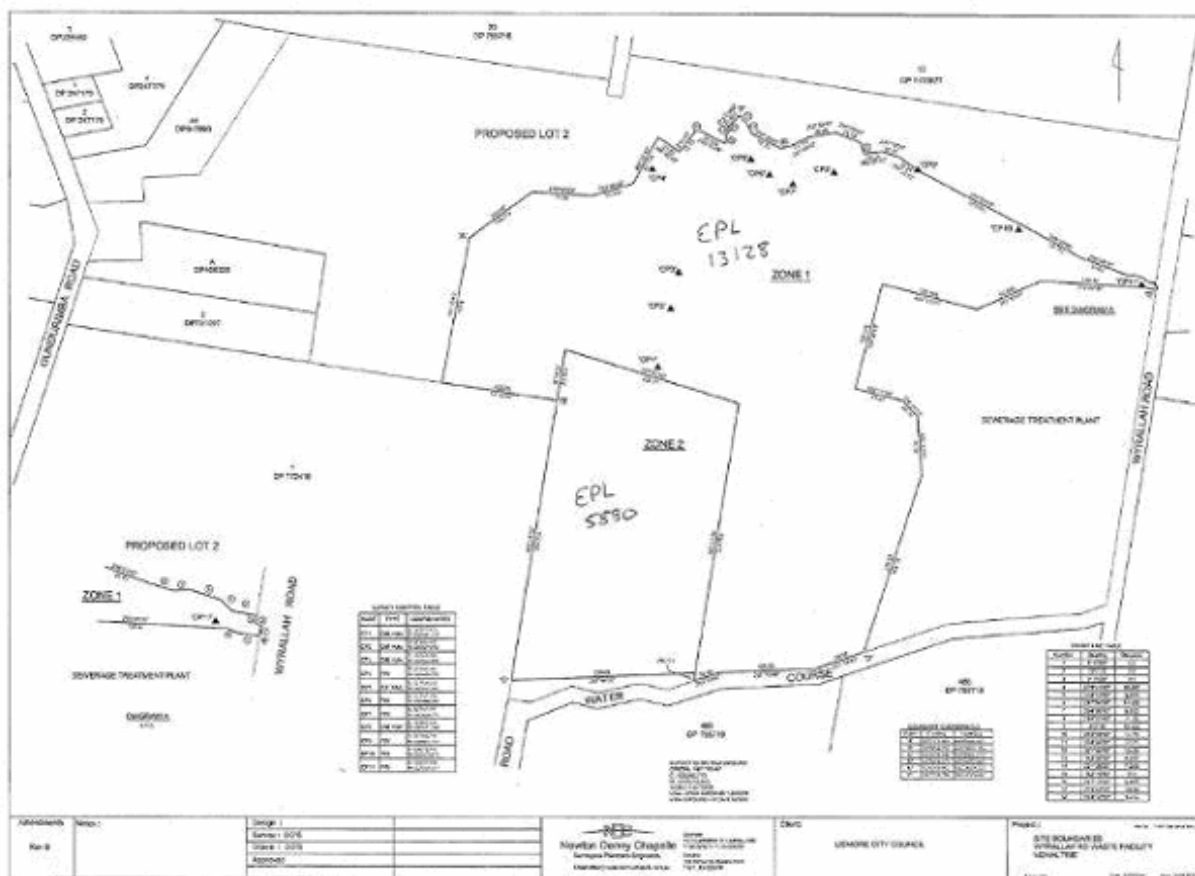

A3 Information supplied to the EPA

A3.1 Works and activities must be carried out in accordance with the proposal contained in the licence application, except as expressly provided by a condition of this licence.

In this condition the reference to "the licence application" includes a reference to:

- a) the applications for any licences (including former pollution control approvals) which this licence replaces under the Protection of the Environment Operations (Savings and Transitional) Regulation 1998; and
- b) the licence information form provided by the licensee to the EPA to assist the EPA in connection with the issuing of this licence.

2 Discharges to Air and Water and Applications to Land

P1 Location of monitoring/discharge points and areas

P1.1 The following points referred to in the table below are identified in this licence for the purposes of monitoring and/or the setting of limits for the emission of pollutants to the air from the point.

Air

Environment Protection Licence

Licence - 5880

EPA identification no.	Type of Monitoring Point	Type of Discharge Point	Location Description
21	Landfill gas monitoring		The surface of all waste filled areas which have been subject to intermediate or final cover/capping.
42	Landfill gas monitoring		All buildings and other enclosed structures within 250 meters of deposited waste or leachate storage.

P1.2 The following utilisation areas referred to in the table below are identified in this licence for the purposes of the monitoring and/or the setting of limits for any application of solids or liquids to the utilisation area.

P1.3 The following points referred to in the table are identified in this licence for the purposes of the monitoring and/or the setting of limits for discharges of pollutants to water from the point.

Water and land

EPA Identification no.	Type of Monitoring Point	Type of Discharge Point	Location Description
3	Groundwater quality and subsurface gas monitoring.		Groundwater monitoring well, marked MW01 on Monitoring Location Map provided to the EPA on 12/10/2018 (Document retained on the EPA's file management system - reference number DOC18/855037)
4	Groundwater quality and subsurface gas monitoring.		Groundwater monitoring well, marked MW02 on Monitoring Location Map provided to the EPA on 12/10/2018 (Document retained on the EPA's file management system - reference number DOC18/855037).
11	Groundwater quality and subsurface gas monitoring.		Groundwater monitoring well, marked MW09 on Monitoring Location Map provided to the EPA 12/10/2018 (Document retained on the EPA's file management system - reference number DOC18/855037).
13	Groundwater quality and subsurface gas monitoring.		Groundwater monitoring bore, marked MW11 on Monitoring Location Map provided to the EPA 12/10/2018 (Document retained on the EPA's file management system - reference number DOC18/855037).

Environment Protection Licence

Licence - 5880

14	Groundwater quality and subsurface gas monitoring.		Groundwater monitoring bore, marked MW12 on Monitoring Location Map provided to the EPA 12/10/2018 (Document retained on the EPA's file management system - reference number DOC18/855037).
17	Surface water quality monitoring		Upstream surface water monitoring point, marked MCS02 on Monitoring Location Map provided to the EPA 12/10/2018 (Document retained on the EPA's file management system - reference number DOC18/855037).
18	Surface water quality monitoring.		Surface water monitoring point, marked MCS03 on Monitoring Location Map provided to the EPA 12/10/2018 (Document retained on the EPA's file management system - reference number DOC18/855037).
19	Surface water quality monitoring.		Surface water monitoring point, marked MCS04 on Monitoring Location Map provided to the EPA 12/10/2018 (Document retained on the EPA's file management system - reference number DOC18/855037).
22	Discharge volume and level monitoring.	Discharge volume and level monitoring.	Leachate Sump - Cell 1, marked L1 on Monitoring Location Map provided to the EPA 12/10/2018 (Document retained on the EPA's file management system - reference number DOC18/855037).
23	Leachate quality monitoring.	Leachate quality monitoring.	Wedge pit marked TWP on Monitoring Location Map provided to the EPA 12/10/2018 (Document retained on the EPA's file management system - reference number DOC18/855037).
24	Groundwater quality monitoring and subsurface gas monitoring.		Groundwater monitoring well, marked MW13 on Monitoring Location Map provided to the EPA 12/10/2018 (Document retained on the EPA's file management system - reference number DOC18/855037).
26	Groundwater quality and subsurface gas monitoring.		Groundwater monitoring well, marked MW15 Monitoring Location Map provided to the EPA 12/10/2018 (Document retained on the EPA's file management system - reference number DOC18/855037).

Environment Protection Licence

Licence - 5880

27	Groundwater quality and subsurface gas monitoring.		Groundwater monitoring well, marked MW16 Monitoring Location Map provided to the EPA 12/10/2018 (Document retained on the EPA's file management system - reference number DOC18/855037).
28	Groundwater quality and subsurface gas monitoring.		Groundwater quality monitoring well, marked MW17 on Monitoring Location Map provided to the EPA 12/10/2018 (Document retained on the EPA's file management system - reference number DOC18/855037).
29	Leachate discharge monitoring.	Leachate discharge monitoring.	Leachate dam, marked LD on Monitoring Location Map provided to the EPA 12/10/2018 (Document retained on the EPA's file management system - reference number DOC18/855037).
31	Groundwater quality monitoring.		Groundwater monitoring well, marked as MW18 on Monitoring Location Map provided to the EPA 12/10/2018 (Document retained on the EPA's file management system - reference number DOC18/855037).
32	Groundwater quality and subsurface gas monitoring.		Groundwater monitoring bore, marked as MW19 on Monitoring Location Map provided to the EPA 12/10/2018 (Document retained on the EPA's file management system - reference number DOC18/855037).
33	Surface water quality monitoring.		Upstream surface water monitoring point, marked as MSC01 on Monitoring Location Map provided to the EPA on 12/10/2018 (Document retained on the EPA 's file management system - reference number DOC18/855037)
34	Discharge volume and level monitoring.	Discharge volume and level monitoring.	Cell 2A Leachate Collection and Removal marked as L2 on Monitoring Location Map provided to the EPA 12/10/2018 (Document retained on the EPA's file management system - reference number DOC18/855037).
35	Groundwater monitoring Well		Groundwater monitoring well marked as MW20 on Monitoring Location Map provided to the EPA 12/10/2018 (Document retained on the EPA's file management system - reference number DOC18/855037).

Environment Protection Licence

Licence - 5880

36	Groundwater monitoring well	Groundwater monitoring well marked as MW21 on Monitoring Location Map provided to the EPA 12/10/2018 (Document retained on the EPA's file management system - reference number DOC18/855037).
37	Groundwater Monitoring Well	Groundwater Monitoring Well marked as MW22 on Monitoring Location Map provided to the EPA 12/10/2018 (Document retained on the EPA's file management system - reference number DOC18/855037).
38	Groundwater Monitoring Well	Groundwater monitoring well marked as MW23 on Monitoring Location Map provided to the EPA 12/10/2018 (Document retained on the EPA's file management system - reference number DOC18/855037).
40	Groundwater Monitoring Well	Groundwater monitoring well marked as MW25 on Monitoring Location Map provided to the EPA 12/10/2018 (Document retained on the EPA's file management system - reference number DOC18/855037).
41	Surface Water Quality	Downstream surface water quality monitoring location marked as MSC05 on Monitoring Location Map provided to the EPA 12/10/2018 (Document retained on the EPA's file management system - reference number DOC18/855037).
43	Leachate discharge	Leachate discharge to East Lismore Sewage Treatment Works located on licence boundary with East Lismore STW. located at GPS location 153.28753 E 28.84197 S (GDA2020).

3 Limit Conditions

L1 Pollution of waters

- L1.1 Except as may be expressly provided in any other condition of this licence, the licensee must comply with section 120 of the Protection of the Environment Operations Act 1997.
- L1.2 The level of leachate in the leachate interception trench (Point 22) must not exceed the level of the base of the waste in Cell 1 adjacent to the leachate interception trench, except as a direct result of rainfall events greater than or equal to 235mm in total falling over any consecutive five day period.

Environment Protection Licence

Licence - 5880

- L1.3 Leachate is permitted to overflow from the leachate management system only as a direct result of a rainfall event of equal to or greater than 235mm in total falling over any consecutive five day period, and only from the spillway of the leachate dam (Point 29).
- L1.4 The level of leachate in the leachate collection well (Point 34) must not exceed the level of the base of the waste in cell 2A, except as a direct result of rainfall events greater than or equal to 235mm in total falling over any consecutive five day period.

L2 Waste

- L2.1 The licensee must not cause, permit or allow any waste to be received at the premises, except the wastes expressly referred to in the column titled "Waste" and meeting the definition, if any, in the column titled "Description" in the table below.
- Any waste received at the premises must only be used for the activities referred to in relation to that waste in the column titled "Activity" in the table below.
- Any waste received at the premises is subject to those limits or conditions, if any, referred to in relation to that waste contained in the column titled "Other Limits" in the table below.
- This condition does not limit any other conditions in this licence.

Code	Waste	Description	Activity	Other Limits
NA	General solid waste (non-putrescible)			See Note
NA	General solid waste (putrescible)			See Note
NA	Asbestos waste			See note
NA	Waste tyres			See Note
NA	General solid waste (non-putrescible)			See Note
NA	Waste			NA

Note: For the purpose of clarifying Condition L2.1, the maximum total limit of waste (consisting of all or any) of "general solid waste (putrescible)", "general solid waste (non-putrescible)", asbestos waste, and waste tyres that can be received at the premises is 40,000t per annum.

L3 Noise limits

- L3.1 Noise from the premises must not exceed:
- an LAeq(15min) noise emission criterion of 50 dB(A) (7am to 6pm) Monday to Friday and 8am to 5pm Saturday;
 - an LAeq(15min) noise emission criterion of 45 dB(A) during the evening (6pm to 10pm) Monday to Friday; and
 - at all other times an LAeq(15min) noise emission criterion of 40 dB(A),

except as expressly provided by this licence.

- L3.2 Noise from the premises is to be measured at the most affected point on or within the affected property boundary or, if this is more than 30 metres from a residence located within the boundaries of the affected

Environment Protection Licence

Licence - 5880

property, at the most affected point within 30 meters of the residence.

L4 Hours of operation

- L4.1 The hours of operation permitted by this licence may be varied where there is no significant impact on the ambient levels outside the premises or at any noise sensitive location. The licensee must provide evidence that no significant impact occurs prior to a variation being granted for the hours of operation.

L5 Potentially offensive odour

- L5.1 No condition of this licence identifies a potentially offensive odour for the purposes of section 129 of the Protection of the Environment Operations Act 1997.

Note: Section 129 of the Protection of the Environment Operations Act 1997, provides that the licensee must not cause or permit the emission of any offensive odour from the premises but provides a defence if the emission is identified in the relevant environment protection licence as a potentially offensive odour and the odour was emitted in accordance with the conditions of a licence directed at minimising odour.

4 Operating Conditions

O1 Activities must be carried out in a competent manner

- O1.1 Licensed activities must be carried out in a competent manner.
This includes:
- a) the processing, handling, movement and storage of materials and substances used to carry out the activity; and
 - b) the treatment, storage, processing, reprocessing, transport and disposal of waste generated by the activity.

O2 Maintenance of plant and equipment

- O2.1 All plant and equipment installed at the premises or used in connection with the licensed activity:
- a) must be maintained in a proper and efficient condition; and
 - b) must be operated in a proper and efficient manner.

O3 Dust

- O3.1 All operations and activities occurring at the premises must be carried out in a manner that will minimise the emission of dust from the premises.

O4 Emergency response

- O4.1 The licensee must extinguish fires at the premises as soon as possible.

Environment Protection Licence

Licence - 5880

- O4.2 The licensee must maintain, and implement as necessary, a current Pollution Incident Response Management Plan (PIRMP) for the premises. The licensee must keep the incident response plan on the premises at all times. The incident response plan must document systems and procedures to deal with all types of incidents (e.g. spills, explosions or fire) that may occur at the premises or that may be associated with activities that occur at the premises and which are likely to cause harm to the environment.

The PIRMP must be tested at least annually or following a pollution incident.

The licensee must develop the PIRMP in accordance with the requirements in Part 5.7A of the Protection of the Environment Operations (POEO) Act 1997 and POEO regulations.

- O4.3 The licensee must have adequate fire prevention measures in place, and ensure that facility personnel are able to access fire-fighting equipment and manage fire outbreaks at any part of the premises .

O5 Processes and management

- O5.1 The licensee must take all practicable steps to control entry to the premises.
- O5.2 The licensee must install and maintain lockable security gates at all access and departure locations.
- O5.3 The licensee must ensure that all gates are locked whenever the landfill is unattended.

O6 Waste management

- O6.1 The last licensee must prepare and submit to the EPA within 12 months prior to the last load of waste being landfilled a closure plan in accordance with section 76 of the Protection of the Environment Operations Act 1997.
- O6.2 Leachate collected at the premises must be discharged to the East Lismore Sewage Treatment Works premises or otherwise transported off the premises to a facility lawfully able to receive the leachate.
- O6.3 The licensee must have in place and maintain a leachate management system that contains any leachate generated from the waste disposed of or stored at the premises.
- O6.4 The licensee must take all practical measures to minimise the amount of leachate held in the leachate trench (point 22), leachate dam (point 29) and leachate collection well (point 34).
- O6.5 There must be no incineration or burning of any waste at the premises.
- O6.6 The licensee must ensure that the landfill cells are capped in accordance with the Environmental Guidelines: Solid Waste Landfills, Second edition 2016.
- O6.7 Cover material must be applied to landfilled areas as specified below:
- a) Daily cover material
Cover must be either
 - i) Virgin excavated natural material ("VENM"), or

Environment Protection Licence

Licence - 5880

ii) Approved alternate daily cover.

b) Daily cover

i) Cover material must be applied over all exposed landfilled waste prior to ceasing operations at the end of each day.

ii) Cover material must be applied to a minimum depth of 15 centimetres unless the approved alternate daily cover is being utilised.

c) Intermediate cover

Cover material must be virgin excavated natural material and must be applied to a depth of 30 centimetres over surfaces of the landfilled waste at the premises which are to be exposed for more than 90 days.

d) Cover material stockpile

At least two weeks cover material must be available at the premises under all weather conditions. This material may be won on site, or alternatively a cover stockpile must be maintained adjacent to the tip face.

Note: Approved alternate daily cover includes:

1. Chipped or mulched vegetation, that complies with resource recovery orders and exemptions, may be used as daily cover during periods of wet weather when access to the active tip face by heavy machinery is not practicable.
2. Landfill lids.
3. Posi-Shell (concrete and general rain shield blends must only be used)

O6.8 Asbestos waste disposed of at the premises must be covered:

- 1) At the time of disposal: with either VENM to a depth of at least 0.15 metres, or with general solid waste to a depth of at least 0.5 m; and
- 2) At the end of each day's operation: with VENM to a depth of at least 0.5 metres; or general solid waste to a depth of at least 1 metre plus an approved daily cover.

O7 Other operating conditions

O7.1 Landfill Cell 2B must be designed, constructed and maintained to prevent flood waters arising from a 1 in 100 year flood event from entering all waste filled areas of the premises.

O7.2 Stormwater and leachate management at the premises must be conducted in accordance with section 6 of the Stormwater and Leachate Management Plan developed by Gilbert and Sutherland Pty Ltd and provided to the EPA on 8 July 2019.

O7.3 By September 1 each year (commencing 1 September 2020) the licensee must submit an indicative program of works, for that financial year, to complete infrastructure and earthworks identified in Attachments 1 and 3 of the Stormwater and Leachate Management Plan developed by Gilbert and Sutherland Pty Ltd and provided to the EPA on 8 July 2019.

O7.4 By 30 October (commencing 30 October 2021) each year the licensee must provide the EPA with a report that details the works that have been completed in accordance with the Stormwater and Leachate Management Plan and Condition O7.3.

Environment Protection Licence

Licence - 5880

5 Monitoring and Recording Conditions

M1 Monitoring records

- M1.1 The results of any monitoring required to be conducted by this licence or a load calculation protocol must be recorded and retained as set out in this condition.
- M1.2 All records required to be kept by this licence must be:
- in a legible form, or in a form that can readily be reduced to a legible form;
 - kept for at least 4 years after the monitoring or event to which they relate took place; and
 - produced in a legible form to any authorised officer of the EPA who asks to see them.
- M1.3 The following records must be kept in respect of any samples required to be collected for the purposes of this licence:
- the date(s) on which the sample was taken;
 - the time(s) at which the sample was collected;
 - the point at which the sample was taken; and
 - the name of the person who collected the sample.

M2 Requirement to monitor concentration of pollutants discharged

- M2.1 For each monitoring/discharge point or utilisation area specified below (by a point number), the licensee must monitor (by sampling and obtaining results by analysis) the concentration of each pollutant specified in Column 1. The licensee must use the sampling method, units of measure, and sample at the frequency, specified opposite in the other columns:

M2.2 Air Monitoring Requirements

POINT 21

Pollutant	Units of measure	Frequency	Sampling Method
Methane	percent by volume	Monthly	Probe

POINT 42

Pollutant	Units of measure	Frequency	Sampling Method
Methane	percent by volume	Monthly	Probe

M2.3 Water and/ or Land Monitoring Requirements

Environment Protection Licence

Licence - 5880

POINT 3,4,11,13,14,24,26,27,28,31,32,35,36,37,38,40

Pollutant	Units of measure	Frequency	Sampling Method
Alkalinity (as calcium carbonate)	milligrams per litre	Yearly	Grab sample
Ammonia	milligrams per litre	Every 6 months	Grab sample
Arsenic	milligrams per litre	Yearly	Grab sample
BOD	milligrams per litre	Every 6 months	Grab sample
Calcium	milligrams per litre	Yearly	Grab sample
Chloride	milligrams per litre	Yearly	Grab sample
Conductivity	microsiemens per centimetre	Every 6 months	Probe
Dissolved organic carbon	milligrams per litre	Every 6 months	Grab sample
Dissolved Oxygen	milligrams per litre	Every 6 months	Probe
Faecal Coliforms	colony forming units per 100 millilitres	Yearly	Grab sample
Fluoride	milligrams per litre	Yearly	Grab sample
Iron	milligrams per litre	Yearly	Grab sample
Magnesium	milligrams per litre	Yearly	Grab sample
Manganese	milligrams per litre	Yearly	Grab sample
Methane	percent by volume	Yearly	Probe
Nitrate	milligrams per litre	Every 6 months	Grab sample
Nitrogen (total)	milligrams per litre	Every 6 months	Grab sample
Organochlorine pesticides	micrograms per litre	Yearly	Grab sample
Organophosphate pesticides	micrograms per litre	Yearly	Grab sample
pH	pH	Every 6 months	Probe
Phosphorus (total)	milligrams per litre	Every 6 months	Grab sample
Potassium	milligrams per litre	Yearly	Grab sample
Redox potential	millivolts	Every 6 months	Probe
Sodium	milligrams per litre	Yearly	Grab sample
Standing Water Level	metres	Every 6 months	In situ
Sulfate	milligrams per litre	Yearly	Grab sample
Temperature	degrees Celsius	Every 6 months	Probe
Total dissolved solids	milligrams per litre	Every 6 months	Grab sample
Total petroleum hydrocarbons	micrograms per litre	Every 6 months	Grab sample
Total Phenolics	milligrams per litre	Yearly	Grab sample

POINT 17,18,19,33,41

Pollutant	Units of measure	Frequency	Sampling Method
Alkalinity (as calcium carbonate)	milligrams per litre	Special Frequency 3	Grab sample
Ammonia	milligrams per litre	Special Frequency 2	Grab sample
BOD	milligrams per litre	Special Frequency 2	Grab sample

Environment Protection Licence

Licence - 5880

Calcium	milligrams per litre	Special Frequency 3	Grab sample
Chloride	milligrams per litre	Special Frequency 3	Grab sample
Conductivity	microsiemens per centimetre	Special Frequency 2	Probe
Dissolved organic carbon	milligrams per litre	Special Frequency 2	Grab sample
Dissolved Oxygen	milligrams per litre	Special Frequency 2	Probe
Faecal Coliforms	colony forming units per 100 millilitres	Special Frequency 2	Grab sample
Fluoride	milligrams per litre	Special Frequency 3	Grab sample
Iron	milligrams per litre	Special Frequency 3	Grab sample
Magnesium	milligrams per litre	Special Frequency 3	Grab sample
Manganese	milligrams per litre	Special Frequency 3	Grab sample
Nitrate	milligrams per litre	Special Frequency 2	Grab sample
Nitrogen (total)	milligrams per litre	Special Frequency 2	Grab sample
pH	pH	Special Frequency 2	Probe
Phosphorus (total)	milligrams per litre	Special Frequency 2	Grab sample
Potassium	milligrams per litre	Special Frequency 3	Grab sample
Redox potential	millivolts	Special Frequency 2	Probe
Sodium	milligrams per litre	Special Frequency 3	Grab sample
Sulfate	milligrams per litre	Special Frequency 3	Grab sample
Temperature	degrees Celsius	Special Frequency 2	Probe
Total dissolved solids	milligrams per litre	Special Frequency 2	Grab sample
Total petroleum hydrocarbons	milligrams per litre	Special Frequency 2	Grab sample
Total Phenolics	milligrams per litre	Special Frequency 3	Grab sample
Total suspended solids	milligrams per litre	Special Frequency 2	Grab sample
Turbidity	nephelometric turbidity units	Special Frequency 2	Probe

POINT 23,29

Pollutant	Units of measure	Frequency	Sampling Method
Alkalinity (as calcium carbonate)	milligrams per litre	Special Frequency 2	Grab sample
Ammonia	milligrams per litre	Special Frequency 2	Grab sample
Arsenic	milligrams per litre	Special Frequency 2	Grab sample
Calcium	milligrams per litre	Special Frequency 2	Grab sample
Chemical oxygen demand	milligrams per litre	Special Frequency 2	Grab sample
Chloride	milligrams per litre	Special Frequency 2	Grab sample
Conductivity	microsiemens per centimetre	Special Frequency 2	Probe
Dissolved organic carbon	milligrams per litre	Special Frequency 2	Grab sample
Faecal Coliforms	colony forming units per 100 millilitres	Special Frequency 2	Grab sample
Fluoride	milligrams per litre	Special Frequency 2	Grab sample
Magnesium	milligrams per litre	Special Frequency 2	Grab sample

Environment Protection Licence

Licence - 5880

Nitrate	milligrams per litre	Special Frequency 2	Grab sample
Nitrogen (total)	milligrams per litre	Special Frequency 2	Grab sample
Organochlorine pesticides	micrograms per litre	Every 6 months	Grab sample
Organophosphate pesticides	micrograms per litre	Every 6 months	Grab sample
pH	pH	Special Frequency 2	Probe
Phosphorus (total)	milligrams per litre	Special Frequency 2	Grab sample
Potassium	milligrams per litre	Special Frequency 2	Grab sample
Sodium	milligrams per litre	Special Frequency 2	Grab sample
Sulfate	milligrams per litre	Special Frequency 2	Grab sample
Total dissolved solids	milligrams per litre	Special Frequency 2	Grab sample

M2.4 For the purpose of the table(s) above Special Frequency 2 means the collection of samples quarterly, at a time when flow is occurring.

M2.5 For the purpose of the table(s) above Special Frequency 3 means the collection of samples yearly, at a time when flow is occurring.

M3 Testing methods - concentration limits

M3.1 Monitoring for the concentration of a pollutant emitted to the air required to be conducted by this licence must be done in accordance with:

- any methodology which is required by or under the Act to be used for the testing of the concentration of the pollutant; or
- if no such requirement is imposed by or under the Act, any methodology which a condition of this licence requires to be used for that testing; or
- if no such requirement is imposed by or under the Act or by a condition of this licence, any methodology approved in writing by the EPA for the purposes of that testing prior to the testing taking place.

Note: The *Protection of the Environment Operations (Clean Air) Regulation 2022* requires testing for certain purposes to be conducted in accordance with test methods contained in the publication "Approved Methods for the Sampling and Analysis of Air Pollutants in NSW".

M3.2 Subject to any express provision to the contrary in this licence, monitoring for the concentration of a pollutant discharged to waters or applied to a utilisation area must be done in accordance with the Approved Methods Publication unless another method has been approved by the EPA in writing before any tests are conducted.

M4 Weather monitoring

M4.1 The following daily weather parameters must be monitored and recorded:

- Rainfall at the premises must be measured and recorded in millimetres per 24 hour period, at the same time each day.
- Wind speed and direction - hourly during operating hours.

Environment Protection Licence

Licence - 5880

3. Temperature - hourly during operating hours.

M5 Recording of pollution complaints

M5.1 The licensee must keep a legible record of all complaints made to the licensee or any employee or agent of the licensee in relation to pollution arising from any activity to which this licence applies.

M5.2 The record must include details of the following:

- a) the date and time of the complaint;
- b) the method by which the complaint was made;
- c) any personal details of the complainant which were provided by the complainant or, if no such details were provided, a note to that effect;
- d) the nature of the complaint;
- e) the action taken by the licensee in relation to the complaint, including any follow-up contact with the complainant; and
- f) if no action was taken by the licensee, the reasons why no action was taken.

M5.3 The record of a complaint must be kept for at least 4 years after the complaint was made.

M5.4 The record must be produced to any authorised officer of the EPA who asks to see them.

M6 Telephone complaints line

M6.1 The licensee must operate during its operating hours a telephone complaints line for the purpose of receiving any complaints from members of the public in relation to activities conducted at the premises or by the vehicle or mobile plant, unless otherwise specified in the licence.

M6.2 The licensee must notify the public of the complaints line telephone number and the fact that it is a complaints line so that the impacted community knows how to make a complaint.

M6.3 The preceding two conditions do not apply until 3 months after: the date of the issue of this licence.

M7 Requirement to monitor volume or mass

M7.1 For Points 22,29 and 34, the licensee must monitor on a daily basis the volume of leachate discharged.

M7.2 For Point 22 the licensee must monitor the level of leachate held in the Point on a Daily basis using an Instrumental sampling method and cm for units of measure.

M7.3 For Point 29 the licensee must monitor the level of leachate and the remaining freeboard on a daily basis using a Graduate in-situ marker, and cm for units of measure.

M7.4 Samples taken pursuant to a requirement in this licence to monitor the volume, mass or concentration of pollutants, must be analysed and reported in accordance with the laboratory accreditation requirements set

Environment Protection Licence

Licence - 5880

out in section 2.1.3 of the Load Calculation Protocol.

The Load Calculation Protocol is the Protocol referred to in clause 18 of the Protection of the Environment Operations (General) Regulation 1998. A copy of the Protocol was published in the Government Gazette on 25 June 1999.

6 Reporting Conditions

R1 Annual return documents

R1.1 The licensee must complete and supply to the EPA an Annual Return in the approved form comprising:

1. a Statement of Compliance,
2. a Monitoring and Complaints Summary,
3. a Statement of Compliance - Licence Conditions,
4. a Statement of Compliance - Load based Fee,
5. a Statement of Compliance - Requirement to Prepare Pollution Incident Response Management Plan,
6. a Statement of Compliance - Requirement to Publish Pollution Monitoring Data; and
7. a Statement of Compliance - Environmental Management Systems and Practices.

At the end of each reporting period, the EPA will provide to the licensee notification that the Annual Return is due.

R1.2 The Annual Return for the reporting period must be supplied to the EPA via eConnect *EPA* or by registered post not later than 60 days after the end of each reporting period or in the case of a transferring licence not later than 60 days after the date the transfer was granted (the 'due date').

R1.3 The licensee must retain a copy of the Annual Return supplied to the EPA for a period of at least 4 years after the Annual Return was due to be supplied to the EPA.

R1.4 Within the Annual Return, the Statements of Compliance must be certified and the Monitoring and Complaints Summary must be signed by:

- a) the licence holder; or
- b) by a person approved in writing by the EPA to sign on behalf of the licence holder.

Note: The term "reporting period" is defined in the dictionary at the end of this licence. Do not complete the Annual Return until after the end of the reporting period.

Note: An application to transfer a licence must be made in the approved form for this purpose.

R1.5 An Annual Return must be prepared in respect of each reporting period, except as provided below.

R1.6 Where this licence is transferred from the licensee to a new licensee:

- a) the transferring licensee must prepare an Annual Return for the period commencing on the first day of the reporting period and ending on the date the application for the transfer of the licence to the new licensee is granted; and
- b) the new licensee must prepare an Annual Return for the period commencing on the date the application for

Environment Protection Licence

Licence - 5880

the transfer of the licence is granted and ending on the last day of the reporting period.

- R1.7 Where this licence is surrendered by the licensee or revoked by the EPA or Minister, the licensee must prepare an Annual Return in respect of the period commencing on the first day of the reporting period and ending on:
- in relation to the surrender of a licence - the date when notice in writing of approval of the surrender is given; or
 - in relation to the revocation of the licence - the date from which notice revoking the licence operates.

R2 Notification of environmental harm

- R2.1 Notifications must be made by telephoning the Environment Line service on 131 555.
- R2.2 The licensee must provide written details of the notification to the EPA within 7 days of the date on which they became aware of the incident.
- R2.3 The licensee must notify the EPA in accordance with condition R2 when:
- the leachate level at monitoring Points 22 and 34 exceeds the level of the base of the waste adjacent to those monitoring points; or
 - leachate overflows from the spillway of leachate dam (Point 29).
- R2.4 The written details required by the above condition must include the following information:
- the volume of the leachate discharged and over what time period the discharge occurred;
 - the date and time of the commencement of the overflow;
 - the weather conditions at the time of the discharge, specifying the amount of rainfall on a daily basis that had fallen:
 - on the day(s) of the discharge; and
 - for the one week period prior to the discharge.
 - the most recent monitoring results of the chemical composition of the leachate;
 - an explanation as to why the discharge occurred;
 - the location(s) of the discharge;
 - was the discharge permitted by this licence, and if not;
 - a plan of action to prevent a similar discharge in the future;

Note: The licensee or its employees must notify all relevant authorities of incidents causing or threatening material harm to the environment immediately after the person becomes aware of the incident in accordance with the requirements of Part 5.7 of the Act.

- R2.5 The EPA must be notified within 24 hours if the landfill gas monitoring required by condition M2.1 indicates a methane gas concentration greater than 1.25% (v/v), and increase the frequency of monitoring to daily, until the EPA determines otherwise.

R3 Written report

- R3.1 Where an authorised officer of the EPA suspects on reasonable grounds that:
- where this licence applies to premises, an event has occurred at the premises; or
 - where this licence applies to vehicles or mobile plant, an event has occurred in connection with the carrying out of the activities authorised by this licence,

Environment Protection Licence

Licence - 5880

and the event has caused, is causing or is likely to cause material harm to the environment (whether the harm occurs on or off premises to which the licence applies), the authorised officer may request a written report of the event.

- R3.2 The licensee must make all reasonable inquiries in relation to the event and supply the report to the EPA within such time as may be specified in the request.
- R3.3 The request may require a report which includes any or all of the following information:
- the cause, time and duration of the event;
 - the type, volume and concentration of every pollutant discharged as a result of the event;
 - the name, address and business hours telephone number of employees or agents of the licensee, or a specified class of them, who witnessed the event;
 - the name, address and business hours telephone number of every other person (of whom the licensee is aware) who witnessed the event, unless the licensee has been unable to obtain that information after making reasonable effort;
 - action taken by the licensee in relation to the event, including any follow-up contact with any complainants;
 - details of any measure taken or proposed to be taken to prevent or mitigate against a recurrence of such an event; and
 - any other relevant matters.
- R3.4 The EPA may make a written request for further details in relation to any of the above matters if it is not satisfied with the report provided by the licensee. The licensee must provide such further details to the EPA within the time specified in the request.

R4 Annual system performance report

- R4.1 The licensee must submit to the EPA an annual water contamination detection monitoring program report for ground water and surface water by 30 October each year. The annual report must as a minimum incorporate the following:
- The results of all water monitoring undertaken over the 12 months period and an assessment of the results against the trigger levels established in the URS report dated 21 December 2004 titled 'Review of Water Characterisation Monitoring Program Wyrallah Road Waste Facility Lismore NSW';
 - A tabular and graphical representation of contamination levels for the annual reporting period compared to previous reporting periods and an assessment of any changes and trends over time;
 - An assessment of the nature and level of (and changes to) any human health and environmental risk, with respect to all sensitive receivers including Monaltrie Creek and off-site groundwater and the uses of those waters;
 - Any further mitigation measures proposed to be implemented for the subsequent 12 months period to further reduce contamination levels and risks to human health and the environment.

R5 Other reporting conditions

- R5.1 The licensee must maintain a daily log and record the following data of fires at the site:
- Time and date when the fire was deliberately started or reported.
 - Whether the fire was authorised by the licensee, and, if not, the circumstances which ignited the fire.
 - The time and date that the fire ceased and whether it burnt out or was extinguished.
 - The location of fire (eg. clean timber stockpile, putrescible garbage cell, etc).

Environment Protection Licence

Licence - 5880

- e) Prevailing weather conditions.
- f) Observations made in regard to smoke direction and dispersion.
- g) The amount of waste that was combusted by the fire.
- h) Action taken to extinguish the fire.

R5.2 The licensee or its employees or agents must notify the EPA in accordance with conditions R2.1 and R2.2 of all fires at the premises as soon as practical after becoming aware of the incident.

7 General Conditions

G1 Copy of licence kept at the premises or plant

- G1.1 A copy of this licence must be kept at the premises to which the licence applies.
- G1.2 The licence must be produced to any authorised officer of the EPA who asks to see it.
- G1.3 The licence must be available for inspection by any employee or agent of the licensee working at the premises.

8 Special Conditions

E1 Cell 1 Phytocap

- E1.1 Within three (3) months following the installation of the capping on Cell 1, the licensee must forward to the EPA a Constuction Quality Assurance (CQA) Report providing:
 - a) As constucted drawings prepared from field surveys depicting the lower and upper levels of the installed engineering clay sealing layer and the upper levels of the vegetation layer;
 - b) Photographic evidence of the measures outlines in a) above; and
 - c) Test results which provide an indication of the permeability of the engineered clay sealing layer (suitable tests include moisture content, density, saturated hydraulic conductivity or equivalent).
 - E1.2 Final capping and revegetation of landfill cells must be completed in accordance with the Phytocapping Technical Specification and the Construction Quality Assurance (CQA) Plan produced by Insitu Advisory Pty Ltd and provided to the EPA on 24 May 2019.
- ### E2 Special Dictionary
- E2.1 Leachate means liquid released by, or water that has percolated through waste and which contains dissolved and/or suspended solids and/or gases.

Environment Protection Licence

Licence - 5880

E3 Leachate Treatment Trial and Discharge

E3.1 An on-site leachate treatment trial is authorised to be carried out to treat water currently being held in the leachate dam and in landfill cell 2B. This trial is authorised to be conducted until 31 January 2025.

E3.2 Treated leachate is authorised to be discharged from the premises in accordance with information and maps provided by Public Works Advisory (PWA) on 30/06/2022 (reference DOC22/552550). Prior to discharge the water quality must be determined to be below the discharge criteria provided by ENV Solutions on 15 July 2022 (reference DOC22/713176). Treated leachate water quality results must be provided to and endorsed by the EPA prior to the discharge commencing.

Note:

1. EPA must be notified when a discharge of treated leachate commences and ceases.
2. When determining the background level for parameters an average of the previous 4 weeks of available data (as provided by the EPA and at point 3) must be used.

Environment Protection Licence

Licence - 5880

Dictionary

General Dictionary

3DGM [in relation to a concentration limit]	Means the three day geometric mean, which is calculated by multiplying the results of the analysis of three samples collected on consecutive days and then taking the cubed root of that amount. Where one or more of the samples is zero or below the detection limit for the analysis, then 1 or the detection limit respectively should be used in place of those samples
Act	Means the Protection of the Environment Operations Act 1997
activity	Means a scheduled or non-scheduled activity within the meaning of the Protection of the Environment Operations Act 1997
actual load	Has the same meaning as in the Protection of the Environment Operations (General) Regulation 2009
AM	Together with a number, means an ambient air monitoring method of that number prescribed by the <i>Approved Methods for the Sampling and Analysis of Air Pollutants in New South Wales</i> .
AMG	Australian Map Grid
anniversary date	The anniversary date is the anniversary each year of the date of issue of the licence. In the case of a licence continued in force by the Protection of the Environment Operations Act 1997, the date of issue of the licence is the first anniversary of the date of issue or last renewal of the licence following the commencement of the Act.
annual return	Is defined in R1.1
Approved Methods Publication	Has the same meaning as in the Protection of the Environment Operations (General) Regulation 2009
assessable pollutants	Has the same meaning as in the Protection of the Environment Operations (General) Regulation 2009
BOD	Means biochemical oxygen demand
CEM	Together with a number, means a continuous emission monitoring method of that number prescribed by the <i>Approved Methods for the Sampling and Analysis of Air Pollutants in New South Wales</i> .
COD	Means chemical oxygen demand
composite sample	Unless otherwise specifically approved in writing by the EPA, a sample consisting of 24 individual samples collected at hourly intervals and each having an equivalent volume.
cond.	Means conductivity
environment	Has the same meaning as in the Protection of the Environment Operations Act 1997
environment protection legislation	Has the same meaning as in the Protection of the Environment Administration Act 1991
EPA	Means Environment Protection Authority of New South Wales.
fee-based activity classification	Means the numbered short descriptions in Schedule 1 of the Protection of the Environment Operations (General) Regulation 2009.
general solid waste (non-putrescible)	Has the same meaning as in Part 3 of Schedule 1 of the Protection of the Environment Operations Act 1997

Environment Protection Licence

Licence - 5880

flow weighted composite sample	Means a sample whose composites are sized in proportion to the flow at each composites time of collection.
general solid waste (putrescible)	Has the same meaning as in Part 3 of Schedule 1 of the Protection of the Environment Operations Act 1997
grab sample	Means a single sample taken at a point at a single time
hazardous waste	Has the same meaning as in Part 3 of Schedule 1 of the Protection of the Environment Operations Act 1997
licensee	Means the licence holder described at the front of this licence
load calculation protocol	Has the same meaning as in the Protection of the Environment Operations (General) Regulation 2009
local authority	Has the same meaning as in the Protection of the Environment Operations Act 1997
material harm	Has the same meaning as in section 147 Protection of the Environment Operations Act 1997
MBAS	Means methylene blue active substances
Minister	Means the Minister administering the Protection of the Environment Operations Act 1997
mobile plant	Has the same meaning as in Part 3 of Schedule 1 of the Protection of the Environment Operations Act 1997
motor vehicle	Has the same meaning as in the Protection of the Environment Operations Act 1997
O&G	Means oil and grease
percentile [in relation to a concentration limit of a sample]	Means that percentage [eg.50%] of the number of samples taken that must meet the concentration limit specified in the licence for that pollutant over a specified period of time. In this licence, the specified period of time is the Reporting Period unless otherwise stated in this licence.
plant	Includes all plant within the meaning of the Protection of the Environment Operations Act 1997 as well as motor vehicles.
pollution of waters [or water pollution]	Has the same meaning as in the Protection of the Environment Operations Act 1997
premises	Means the premises described in condition A2.1
public authority	Has the same meaning as in the Protection of the Environment Operations Act 1997
regional office	Means the relevant EPA office referred to in the Contacting the EPA document accompanying this licence
reporting period	For the purposes of this licence, the reporting period means the period of 12 months after the issue of the licence, and each subsequent period of 12 months. In the case of a licence continued in force by the Protection of the Environment Operations Act 1997, the date of issue of the licence is the first anniversary of the date of issue or last renewal of the licence following the commencement of the Act.
restricted solid waste	Has the same meaning as in Part 3 of Schedule 1 of the Protection of the Environment Operations Act 1997
scheduled activity	Means an activity listed in Schedule 1 of the Protection of the Environment Operations Act 1997
special waste	Has the same meaning as in Part 3 of Schedule 1 of the Protection of the Environment Operations Act 1997
TM	Together with a number, means a test method of that number prescribed by the <i>Approved Methods for the Sampling and Analysis of Air Pollutants in New South Wales</i> .

Environment Protection Licence

Licence - 5880

TSP	Means total suspended particles
TSS	Means total suspended solids
Type 1 substance	Means the elements antimony, arsenic, cadmium, lead or mercury or any compound containing one or more of those elements
Type 2 substance	Means the elements beryllium, chromium, cobalt, manganese, nickel, selenium, tin or vanadium or any compound containing one or more of those elements
utilisation area	Means any area shown as a utilisation area on a map submitted with the application for this licence
waste	Has the same meaning as in the Protection of the Environment Operations Act 1997
waste type	Means liquid, restricted solid waste, general solid waste (putrescible), general solid waste (non-putrescible), special waste or hazardous waste
Wellhead	Has the same meaning as in Schedule 1 to the Protection of the Environment Operations (General) Regulation 2021.

Mr Graeme Budd

Environment Protection Authority

(By Delegation)

Date of this edition: 15-March-2001

Environment Protection Licence

Licence - 5880

End Notes

- 1 Licence varied by notice 1022335, issued on 26-Mar-2003, which came into effect on 20-Apr-2003.
- 2 Licence varied by notice 1030226, issued on 16-Oct-2003, which came into effect on 10-Nov-2003.
- 3 Licence varied by notice 1036989, issued on 30-Jul-2004, which came into effect on 24-Aug-2004.
- 4 Licence varied by notice 1042088, issued on 12-Nov-2004, which came into effect on 07-Dec-2004.
- 5 Licence varied by notice 1042980, issued on 14-Feb-2005, which came into effect on 11-Mar-2005.
- 6 Licence varied by notice 1045387, issued on 29-Apr-2005, which came into effect on 24-May-2005.
- 7 Licence varied by notice 1056304, issued on 22-Feb-2006, which came into effect on 19-Mar-2006.
- 8 Licence varied by notice 1065649, issued on 01-Nov-2006, which came into effect on 01-Nov-2006.
- 9 Licence varied by notice 1074240, issued on 04-Jun-2007, which came into effect on 04-Jun-2007.
- 10 Condition A1.3 Not applicable varied by notice issued on <issue date> which came into effect on <effective date>
- 11 Licence varied by notice 1097470, issued on 20-Mar-2009, which came into effect on 20-Mar-2009.
- 12 Licence varied by notice 1102181, issued on 23-Jul-2009, which came into effect on 23-Jul-2009.
- 13 Licence varied by notice 1110624, issued on 23-Feb-2010, which came into effect on 23-Feb-2010.
- 14 Licence varied by Correction to EPA Region data record., issued on 21-Jun-2010, which came into effect on 21-Jun-2010.
- 15 Licence varied by Correction to EPA Region data record., issued on 22-Jun-2010, which came into effect on 22-Jun-2010.
- 16 Licence varied by notice 1118800, issued on 17-Sep-2010, which came into effect on 17-Sep-2010.
- 17 Licence varied by notice 1502516 issued on 03-Jun-2013
- 18 Licence varied by notice 1523691 issued on 30-Nov-2015
- 19 Licence varied by notice 1565909 issued on 10-Apr-2019



Environment Protection Licence

Licence - 5880

20	Licence varied by notice	1581190 issued on 02-Aug-2019
21	Licence varied by notice	1591022 issued on 23-Mar-2020
22	Licence varied by notice	1600563 issued on 22-Sep-2020
23	Licence varied by notice	1613570 issued on 16-Nov-2021
24	Licence varied by notice	1620159 issued on 08-Jul-2022
25	Licence varied by notice	1621411 issued on 31-Aug-2022
26	Licence varied by notice	1626316 issued on 30-Jan-2023
27	Licence varied by notice	1631113 issued on 24-Jul-2023